

# KAUPULEHU PHASE 2 Lot 32 DRAFT

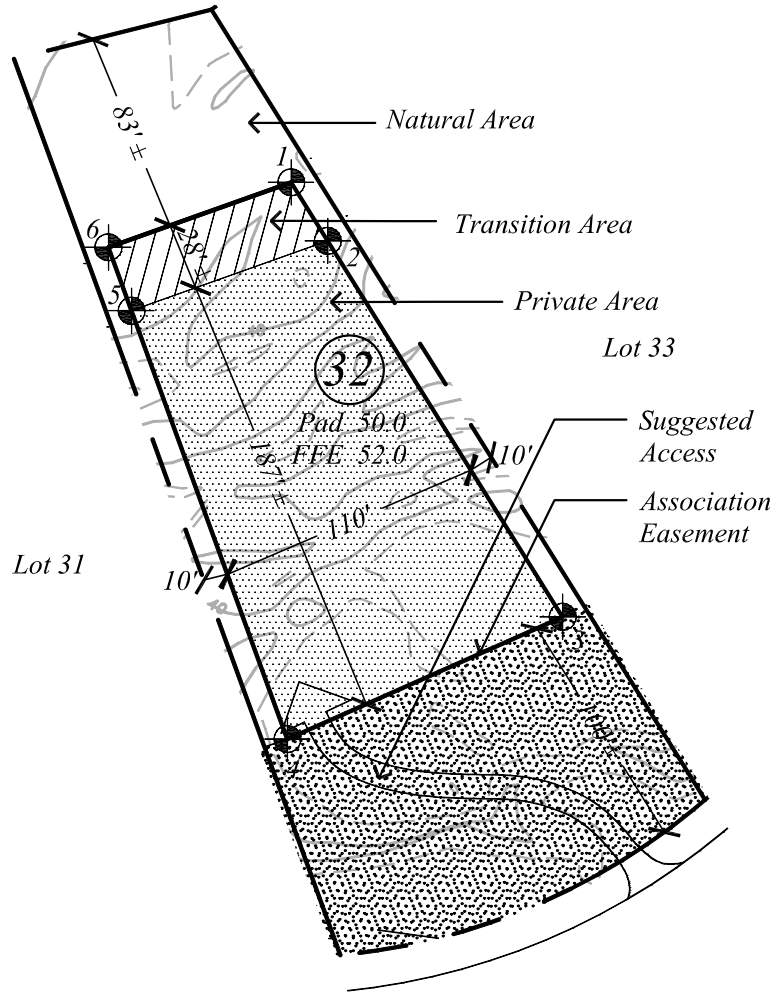

January 15, 2007  
October 12, 2006  
May 17, 2006  
January 3, 2006

## LEGEND

<div style="border: 1px solid black; width: 40px; height: 15px; margin-bottom: 5px;"></div> <div style="border: 1px solid black; width: 40px; height: 15px; background: repeating-linear-gradient(45deg, transparent, transparent 2px, black 2px, black 4px); margin-bottom: 5px;"></div> <div style="border: 1px solid black; width: 40px; height: 15px; background: radial-gradient(circle, black 1px, transparent 1px); background-size: 4px 4px; margin-bottom: 5px;"></div> <div style="border: 1px solid black; width: 40px; height: 15px; background: radial-gradient(circle, black 1px, transparent 1px); background-size: 4px 4px; opacity: 0.5; margin-bottom: 5px;"></div> <div style="border: 1px solid black; width: 40px; height: 15px; background: radial-gradient(circle, black 1px, transparent 1px); background-size: 4px 4px; opacity: 0.2; margin-bottom: 5px;"></div>	<p>Natural Area</p> <p>Transition Area</p> <p>Private Area</p> <p>Association Easement</p> <p>Preserved Lava Outcrops</p>	<div style="border-top: 1px dashed black; width: 40px; height: 1px; margin-bottom: 5px;"></div> <div style="border-top: 2px solid black; width: 40px; height: 1px; margin-bottom: 5px;"></div> <div style="border-top: 1px dashed black; width: 40px; height: 1px; margin-bottom: 5px;"></div> <div style="border-top: 1px dashed black; width: 40px; height: 1px; margin-bottom: 5px;"></div> <div style="text-align: center; margin-bottom: 5px;"> </div>	<p>Lot Boundary</p> <p>Building Envelope Boundary</p> <p>Subzone Line</p> <p>150' Setback</p> <p>Stake Location and Number</p>
--	---	---	--

Lot Area: 1.12 AC ±  
 Private Area: 19,709 SF ±  
 Building Envelope Area: 22,065 SF ±  
 Building Height Max. Elevation: 70.0' (18' height)  
 Max. Irrigated Area/Quantity: 14,761 SF ± 2,203 GPD

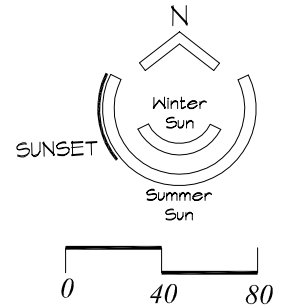

The locations of the Private Area, Natural Area, Transition Area, Association Easement and other physical structures and height of the pad elevation depicted on this diagram are approximations. Purchasers are advised to verify the same prior to commencing construction. Please see reverse side for additional information. All elevations are from sea level which is elevation 0'.